

LOCATION MAP

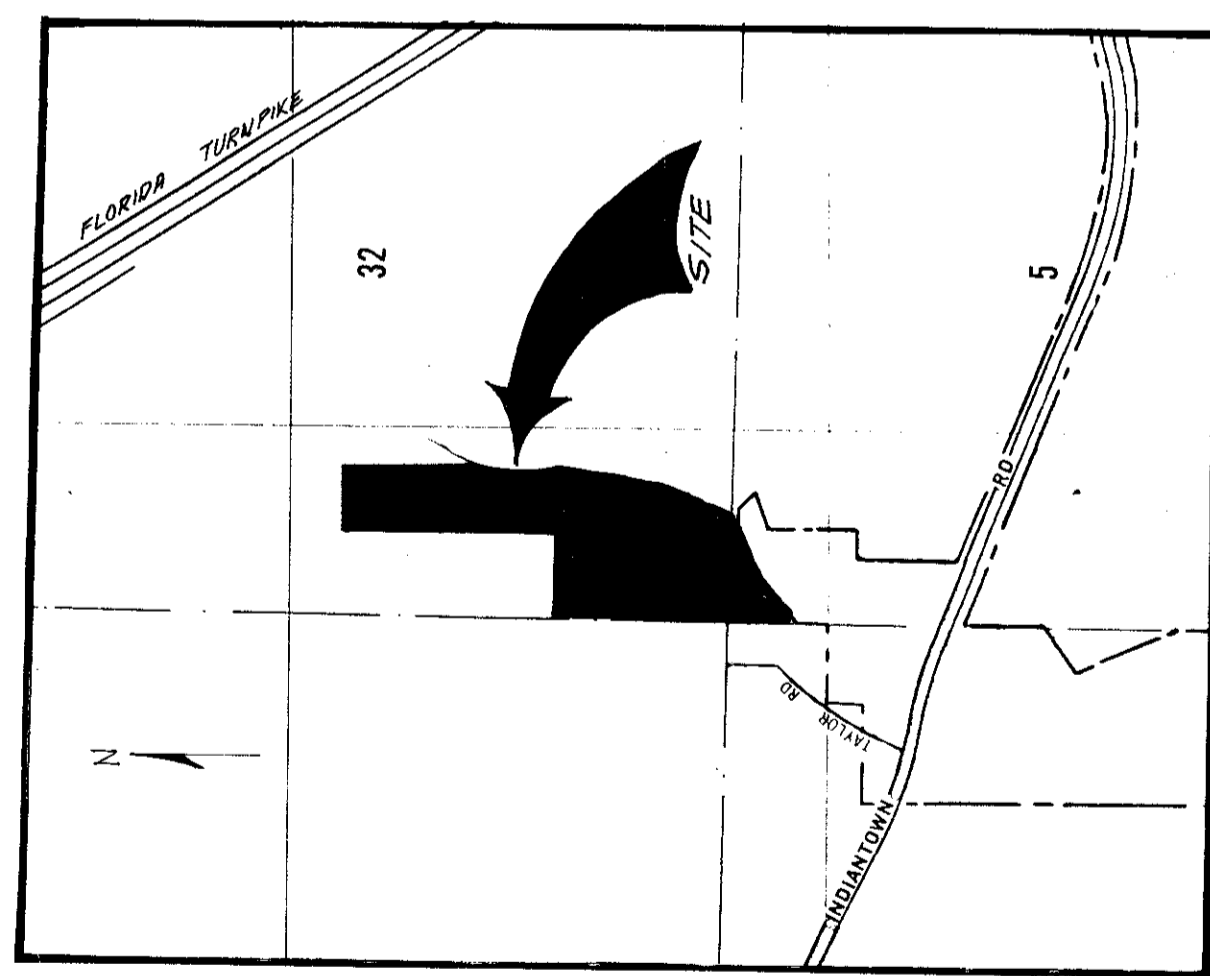

LEGAL DESCRIPTION

PARCEL 1
 A PARCEL OF LAND LYING IN SECTION 32, TOWNSHIP 40 SOUTH, RANGE 42 EAST, PALM BEACH COUNTY, FLORIDA; BEING MORE PARTICULARLY DESCRIBED AS FOLLOWS:
 THE SOUTHWEST QUARTER OF THE SOUTHWEST QUARTER; THE EAST HALF OF THE NORTHWEST QUARTER OF THE SOUTHWEST QUARTER AND THE SOUTH HALF OF THE SOUTHEAST QUARTER OF THE SOUTHWEST QUARTER OF THE NORTHWEST QUARTER. LESS HOWEVER THE FOLLOWING DESCRIBED PARCEL;
 BEGIN AT THE NORTHEAST CORNER OF THE NORTHWEST QUARTER OF THE SOUTHWEST QUARTER OF SECTION 32, TOWNSHIP 40 SOUTH, RANGE 42 EAST; THENCE SOUTH ALONG THE EAST LINE OF SAID NORTHWEST QUARTER OF THE SOUTHWEST QUARTER TO A POINT WHERE SAID LINE OR EXTENSION THEREOF, AND THE CENTER LINE OF THE LOXAHATCHEE RIVER INTERSECT, SAID POINT BEING THE POINT OF BEGINNING. THENCE SOUTH ALONG THE EAST LINE OF THE NORTHWEST QUARTER OF THE SOUTHWEST QUARTER AND THE EAST LINE OF THE SOUTHWEST QUARTER OF THE SOUTHWEST QUARTER, (THE EXACT POINT OF INTERSECTION BEING UNDETERMINED) TO THE SOUTHEAST CORNER OF THE SOUTHWEST QUARTER OF THE SOUTHWEST QUARTER. THENCE WEST ALONG THE SOUTH LINE OF THE SOUTHWEST QUARTER OF THE SOUTHWEST QUARTER TO THE POINT WHERE SAID LINE AND THE CENTER LINE OF THE LOXAHATCHEE RIVER INTERSECT; THENCE IN A NORTHEASTERLY DIRECTION MEANDER THE CENTER LINE OF THE LOXAHATCHEE RIVER TO THE POINT OF BEGINNING, ALL IN SECTION 32, TOWNSHIP 40 SOUTH, RANGE 42 EAST, AND BEING AN IRREGULAR TRIANGULAR TRACT OF LAND CONTAINING TEN ACRES MORE OR LESS WITH ITS NORTHWEST HYPOTENUSE SIDE BEING THE CENTER LINE OF THE LOXAHATCHEE RIVER.
 SUBJECT TO EASEMENTS, RESERVATIONS, RESTRICTIONS, AND RIGHTS OF WAY OF RECORD.

PARCEL 2
 A PARCEL OF LAND LYING IN SECTION 5, TOWNSHIP 41 SOUTH, RANGE 42 EAST, PALM BEACH COUNTY, FLORIDA; BEING MORE PARTICULARLY DESCRIBED AS FOLLOWS:
 THAT PART OF THE NORTHWEST QUARTER OF THE NORTHWEST QUARTER, WHICH LIES NORTH AND WEST OF THE LOXAHATCHEE RIVER.
 SUBJECT TO EASEMENTS, RESERVATIONS, RESTRICTIONS, AND RIGHTS OF WAY OF RECORD.

RESTRICTIONS
 CLEARING

SITE PLAN

PREPARED FOR: WILLIAM J. & MARY L. BLANKENSHIP

ur0218.igr
 BLANKENSHIP 32/40/42

DWN. R.H.D.	DATE 17 MAR 1980
CHK. T.L.O.	DWG. NO. J-78-058-A
REVISIONS:	SCALE 1" = 200'
	SHEET OF

DAILEY AND ASSOCIATES
 LAND SURVEYORS
 4115 WEST INDIANTOWN ROAD
 JUPITER, FLORIDA 33458
 PHONE: (305) 746-8424